

Pipe Grounding Clamp

Used for bonding to water pipe, gas lines and pipe railing.

For use with all standard conductor and bonding wire.

- 3501** Cast bronze pipe clamp, up to 1-1/4" **WT 10.0 oz (283.5 g)**
- 3511** Cast bronze pipe clamp, from 1-1/4" to 2-1/4" **WT 1.37 lbs (0.63 kg)**
- 3521** Cast bronze pipe clamp, from 2" to 4-1/2" **WT 1.93 lbs (0.86 kg)**
- 3501A** Cast aluminum pipe clamp, up to 1-1/4" **WT 4.0 oz (113.4 g)**
- 3511A** Cast aluminum pipe clamp, from 1-1/4" to 2-1/4" **WT 9.0 oz (255.1 g)**
- 3521A** Cast aluminum pipe clamp, from 2" to 4-1/2" **WT 12.0 oz (340.2 g)**

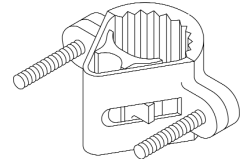

Conduit Bonding Wedges

- 3525** Bronze conduit Bonding Wedge for 1" Conduit **WT 2.0 oz (56.7 g)**
- 3525A** Aluminum conduit Bonding Wedge for 1" Conduit **WT 1.0 oz (28.3 g)**

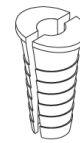

Large Pipe Bonding Strap

Has a terminal bonding lug for standard conductor.

Please call ALLTEC Corporation for sizes not listed.

- 3531** Copper strap/cast bronze terminal lug to 2" pipe **WT 14.0 oz (396.9 g)**
- 3541** Copper strap/cast bronze terminal lug to 4" pipe **WT 1.12 lbs (0.72 kg)**
- 3551** Copper strap/cast bronze terminal lug to 6" pipe **WT 1.62 lbs (0.73 kg)**
- 3561** Copper strap/cast bronze terminal lug to 8" pipe **WT 2.50 lbs (1.13 kg)**
- 3531A** Aluminum strap/cast aluminum terminal lug to 2" pipe **WT 6.0 oz (170.1 g)**
- 3541A** Aluminum strap/cast aluminum terminal lug to 4" pipe **WT 8.0 oz (226.8 g)**
- 3551A** Aluminum strap/cast aluminum terminal lug to 6" pipe **WT 12.0 oz (340.2 g)**
- 3561A** Aluminum strap/cast aluminum terminal lug to 8" pipe **WT 1.12 lbs (0.51 kg)**

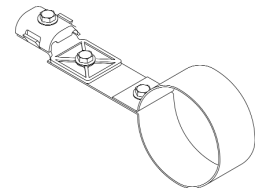

Small Pipe Bonding Strap

Has a terminal bonding lug for secondary and miniature conductor.

Please call ALLTEC Corporation for sizes not listed.

- 3571** Copper strap/cast bronze terminal lug to 2" pipe **WT 6.0 oz (170.1 g)**
- 3581** Copper strap/cast bronze terminal lug to 4" pipe **WT 9.0 oz (225.1 g)**
- 3571A** Aluminum strap/cast aluminum terminal lug to 2" pipe **WT 4.0 oz (113.4 g)**
- 3581A** Aluminum strap/cast aluminum terminal lug to 4" pipe **WT 6.0 oz (170.1 g)**

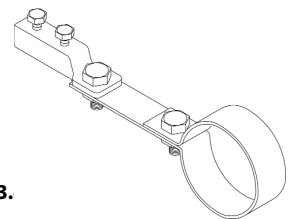

Sill Cock Bonding Clamp

For use on various flange sizes.

Has a bonding lug for standard conductor cable.

- 3591** Cast bronze sill cock bonding clamp **WT 7.0 oz (198.4 g)**
- 3591A** Cast aluminum sill cock bonding clamp **WT 8.0 oz (226.8 g)**

